

# Bench Family, the L-shaped bench

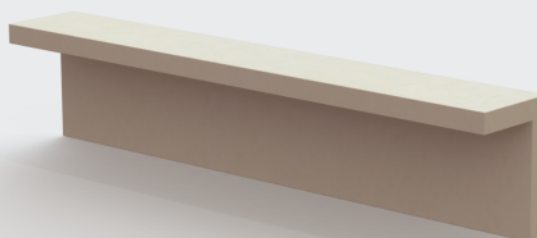

URBASTYLE  
CONCRETE STREET FURNITURE



## Anchoring

- ✓ 2x M12
- ✓ To fix in ground with concrete

## Measurements

- ✓ Family I
  - ✓ 300x40x45 cm - 414 kg
  - ✓ 200x40x45 cm - 276 kg
  - ✓ 100x40x45 cm - 138 kg
- ✓ Family II
  - ✓ 300x40x65 cm - 684 kg
  - ✓ 200x40x65 cm - 456 kg
  - ✓ 100x40x65 cm - 228 kg
- ✓ Family III
  - ✓ 300x40x65 cm - 900 kg
  - ✓ 200x40x65 cm - 600 kg
  - ✓ 100x40x65 cm - 300 kg

Bench Family is an L-shaped bench that comes in 3 different variations for placement. The Bench Family is available in 3 different lengths. You can anchor this Bench Family on or in the ground in 3 different ways. A first possibility is an L-shape with seat height 45 cm and chemical anchoring in the ground using several threaded rods. This is the ideal solution for installing...

## Colours and Finishings

- ✓ FERRO
- ✓ FINO
- ✓ FINERRO
- ✓ VISIA

Accessibility

